

Category: Study conduct-All studies (Government funded/NGO funded/Regulatory)

Title: Storage, safe handling of IP and Maintaining its Temperature Log

SOP No / Version No.: DCP 22 /08

Date first effective: 1 Jan 2026

Review date: 31 Dec 2026

Department of Clinical Pharmacology, 1st Floor, New MS Building,
Seth GS Medical College & KEM Hospital, Parel, Mumbai 400012.

Category: Study conduct-All studies (Government funded/NGO funded/Regulatory)

Title: Storage and handling of Investigational product (IP) and Maintaining its Temperature Records

SOP No / Version No: 22/08

Total pages: 11

Date first effective: 1 Jan 2026

Next Review date: 31 Dec 2026

Version: 08

Author:

1) Dr. Shiva Krishna Rao.T
1st Year DM Resident

Shiva Krishna Rao.T
1/Jan/2026

2) Dr. Shital Bendkhale
Project Scientist- II

Bendkhale
1/JAN/2026

Signature with date

Reviewer:

Dr. Roopa Parida
Assistant Professor

Signature with date

Roopa Parida
01/Jan/26

Approved by:

Dr. Nithya Gogtay
Professor and Head

Nithya Gogtay
01 Jan/26

Signature with date

Confidential

Dr Nithya Gogtay
Professor & Head
Department of Clinical Pharmacology
1st Floor, MS Building
Seth GS Medical College & KEM Hospital
Parel, Mumbai 400 012

Page 1 of 11

Category: Study conduct-All studies (Government funded/NGO funded/Regulatory)

Title: Storage, safe handling of IP and Maintaining its Temperature Log
SOP No / Version No.: DCP 22 /08

Date first effective: 1 Jan 2026 **Review date:** 31 Dec 2026

Department of Clinical Pharmacology, 1st Floor, New MS Building,
Seth GS Medical College & KEM Hospital, Parel, Mumbai 400012.

Table of Contents

No.	Contents	Page No.
1	Purpose	3
2	Responsibility & Scope	3
3	Applicable rules, regulations and guidelines	3
4	Detailed Instructions	4
5	Annexure	10

Category: Study conduct-All studies (Government funded/NGO funded/Regulatory)

Title: Storage, safe handling of IP and Maintaining its Temperature Log

SOP No / Version No.: DCP 22 /08

Date first effective: 1 Jan 2026

Review date: 31 Dec 2026

Department of Clinical Pharmacology, 1st Floor, New MS Building,
Seth GS Medical College & KEM Hospital, Parel, Mumbai 400012.

1. Purpose

This Standard Operating Procedure describes the procedure for storage, handling of investigational product (IP) and maintaining the Temperature Log of the trial medication during the study period.

2. Responsibilities & Scope

Principal investigator, Co-investigator, Pharmacist, Study Coordinator or any other appropriately qualified staff in the team, delegated by the Principal Investigator, will be responsible for storage, handling of IP and maintaining the Temperature log of the trial medication during the study period. Every designated staff will have a backup who will perform the duties in his/her absence.

This SOP is limited to describing the essential steps to be taken by the study staff for the safe handling of study IPs (IPs) in clinical trial and maintenance of temperature as advised by the sponsor during the trial.

3. Applicable rules, regulations and guidelines

- National Ethical Guidelines for Biomedical and Health Research involving Human Participants (2017), https://ethics.ncdirindia.org/ICMR_Ethical_Guidelines.aspx, last accessed on 1st January 2026.
- New Drugs and Clinical Trials Rules (2019), <https://cdsco.gov.in/openems/openems/en/Acts-and-rules/New-Drugs/>, last accessed on 1st January 2026.
- ICH HARMONISED GUIDELINE GOOD CLINICAL PRACTICE (GCP) E6(R3), https://database.ich.org/sites/default/files/ICH_E6%28R3%29_DraftGuideline_2023_0519.pdf, last accessed on 1st January 2026.
- India GCP guidelines (Draft, September 2024), https://ethics.ncdirindia.org/asset/pdf/Indian_GCP_guideline.pdf, last accessed on 1st January 2026.

Confidential

4
1-1-26
Dr. Nitin S. Goyal
Professor
Department of Clinical Pharmacology
1st Floor, MS Building
Seth GS Medical College & KEM Hospital
Parel, Mumbai 400 012

Page 3 of 11

Category: Study conduct-All studies (Government funded/NGO funded/Regulatory)

Title: Storage, safe handling of IP and Maintaining its Temperature Log

SOP No / Version No.: DCP 22 /08

Date first effective: 1 Jan 2026

Review date: 31 Dec 2026

Department of Clinical Pharmacology, 1st Floor, New MS Building,
Seth GS Medical College & KEM Hospital, Parel, Mumbai 400012.

- National Ethical Guidelines for Biomedical Research Involving Children. https://ethics.ncdirindia.org//asset/pdf/National_Ethical_Guidelines_for_BioMedical_Research_Involving_Children.pdf last accessed on 1st January 2026.
- Standard-Operating-Procedures of Institutional Ethics Committee, Seth GS Medical College and KEM Hospital, Mumbai
https://www.kem.edu/wpcontent/uploads/2025/03/SOPs_V7_effective_from_9th_Dec_2024_Seth_GSMC_&_KEMH_Mumbai.pdf V7-effective-from-9th-Dec-2024_.pdf (last accessed 1st Jan, 2026)

4. Detailed Instructions

Staff Training

- The temperatures recorded must be audited regularly at least annually
- Calibration of temperature monitoring device and refrigerator should be maintained & updated as per requirement, desired frequency
- The delegated study team member (preferably the pharmacist) should ascertain the temperature requirements of the IP as per the protocol provided by the sponsor.
- The pharmacist must ensure that the refrigerator for storing of IPs in the Pharmacy room of the ward no.24 of the Department of Clinical Pharmacology, is calibrated.
- Access to the refrigerator in which IP is stored should be restricted. The Pharmacist is responsible to ensure that this is followed. The PI should sign off the access register at least once a week
- If the IP is to be stored at room temperature, it should be stored in Pharmacy room located at ward no. 24 of Department of Clinical Pharmacology, or in Residents Room in Phase 1 unit, 2nd Floor, New MS Building, KEM Hospital depending on the temperature requirement.

Confidential

Dr Nithya Gogtay
Professor & Head
Department of Clinical Pharmacology
1st Floor, MS Building
Seth GS Medical College & KEM Hospital
Parel, Mumbai 400 012

Page 4 of 11

Category: Study conduct-All studies (Government funded/NGO funded/Regulatory)

Title: Storage, safe handling of IP and Maintaining its Temperature Log

SOP No / Version No.: DCP 22 /08

Date first effective: 1 Jan 2026

Review date: 31 Dec 2026

Department of Clinical Pharmacology, 1st Floor, New MS Building,
Seth GS Medical College & KEM Hospital, Parel, Mumbai 400012.

- The refrigerator must be labeled with the name of the study, storage temperature for which the IPs are housed, with the date and due date of calibration.
- Data logger should always be kept with the IP to keep a track of temperature round the clock

4.1. Instructions regarding receipt and placement of IPs in the refrigerator:

- 1) On receipt of study IPs, check the IPs against the expiry date and discrepancies, order for leakage, damage, before signing for them on the receipt form.
- 2) IPs must be refrigerated immediately on receipt and not left out at room temperature.
- 3) Study IPs type, quantity, batch number and expiry date must be recorded together with the date and time received.
- 4) As per study protocol recommendations on storage must be adhered to. The delegated study team member (usually the pharmacist) should ascertain the temperature requirements of the IP as per the protocol provided by the sponsor.
- 5) Study IPs must be kept in their original containers issued by the manufacturer and stored as advised.
- 6) Temperatures reached within the refrigerator must be recorded twice every day (excluding Sunday and any public/bank holidays as per local policy)
- 7) Study IPs must be stored in the main body of the refrigerator, allowing air to circulate around the packages and ensuring there is no obstruction to the refrigerator fan.
- 8) Study IPs must not be stored near to the door of the refrigerator shelf or in the bottom drawers or adjacent to the refrigerator wall.

Confidential

1.1.26
Dr Nithya Gogtay
Professor & Head
Department of Clinical Pharmacology
1st Floor, MS Building
Seth GS Medical College & KEM Hospital
Parel, Mumbai 400 012

Page 5 of 11

Category: Study conduct-All studies (Government funded/NGO funded/Regulatory)

Title: Storage, safe handling of IP and Maintaining its Temperature Log
SOP No / Version No.: DCP 22 /08

Date first effective: 1 Jan 2026

Review date: 31 Dec 2026

Department of Clinical Pharmacology, 1st Floor, New MS Building,
Seth GS Medical College & KEM Hospital, Parel, Mumbai 400012.

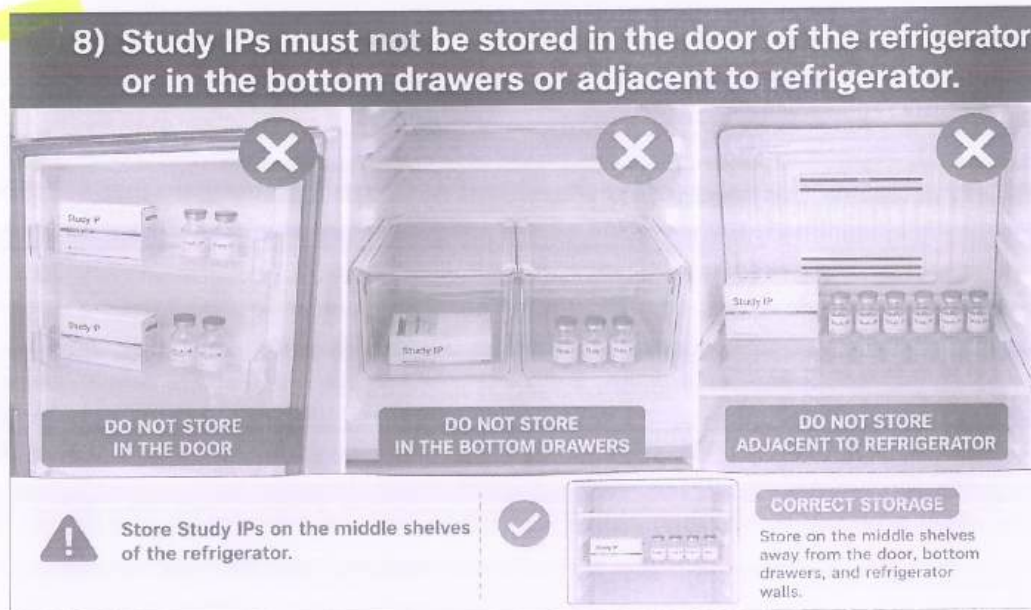

9) IPs must be protected from light.

10) IPs should be placed in the refrigerator such that the vent or fan meant for circulation of air is not blocked and should be evenly distributed across each rack.

11) When 2 or more different IPs are simultaneously administered in a single study, each should be placed on a separate rack and the rack should be labeled accordingly.

4.2 Maintenance of IP Refrigerators

- 1) Refrigerators must not be situated near a radiator or other heat source. They must also be appropriately ^{added} ventilated through Air conditioner.
- 2) Refrigerator plugs and sockets must be covered with tape which reads "DO NOT UNPLUG"
- 3) Refrigerators used for IP storage should be lockable and used exclusively for medicines.
- 4) The door of the refrigerator must not be opened unnecessarily and should not be left open any longer than absolutely necessary.

Dr Nithya Gogtay

Professor & Head

Department of Clinical Pharmacology

1st Floor, MS Building

Seth GS Medical College & KEM Hospital

Parel, Mumbai 400 012

Confidential

Page 6 of 11

1-1-26

Category: Study conduct-All studies (Government funded/NGO funded/Regulatory)

Title: Storage, safe handling of IP and Maintaining its Temperature Log

SOP No / Version No.: DCP 22 /08

Date first effective: 1 Jan 2026

Review date: 31 Dec 2026

Department of Clinical Pharmacology, 1st Floor, New MS Building,
Seth GS Medical College & KEM Hospital, Parel, Mumbai 400012.

- 5) In the event of temperature excursion or refrigerator failing or breaking down, back up refrigerator will be available for that period.
- 6) Calibration of the refrigerator must be done once a year.

4.3. Instructions regarding the data logger or temperature recording device

1. Go through the operations manual for handling of the data logger.
2. If the instructions are not clear, then contact the sponsor /CRO for the operational details.
3. Ensure that the data logger is calibrated and battery is not in a drained state at the time of receipt.
4. Position the probe of the data logger in the center of the storing device.
5. Allow the data logger to get conditioned by placing it in the refrigerator for at least 2 hours before initiating the recording of the temperature.

4.4. Instructions regarding recording of temperature

1. The temperature of the refrigerator should be recorded in °C/ °F as per protocol requirements twice a day (in the morning and evening or at times specified by the protocol) by the study pharmacist. The minimum, maximum and actual temperature at time of recording should be recorded.
2. If the readings are not measured in case of Sundays or public holidays, a comment must be provided stating the reason in the temperature log.
3. The readings should be entered in the temperature log and should be signed and dated by allotted staff and reviewed by the study coordinator.
4. The data logger should be reconfigured at least once a week to capture the true maximum and minimum temperature.
5. Data from the logger should be downloaded (if downloadable) at least once a week and saved into a secure computer by the Pharmacist.

Confidential

Dr Nithya Gogtay
Professor & Head
Department of Clinical Pharmacology
1st Floor, MS Building
Seth GS Medical College & KEM Hospital
Parel, Mumbai 400 012

Page 7 of 11

Category: Study conduct-All studies (Government funded/NGO funded/Regulatory)

Title: Storage, safe handling of IP and Maintaining its Temperature Log

SOP No / Version No.: DCP 22 /08

Date first effective: 1 Jan 2026

Review date: 31 Dec 2026

Department of Clinical Pharmacology, 1st Floor, New MS Building,
Seth GS Medical College & KEM Hospital, Parel, Mumbai 400012.

- 4) Clean surface with Lysol Disinfectant.
- 5) Splashes on the skin must be washed with soap and water.
- 6) Eyes must be washed with copious amounts of 0.9% sodium chloride and medical advice sought

4.12. Use Of Insulated Cool Boxes

- 1) Designated cool boxes should be used.
- 2) It is strongly recommended that the cool box is monitored with a thermometer.

4.13. Treatment And Final Disposal

Will be carried as per SOP 24 (Waste Disposal)

Annexure 1: Template of temperature log

TEMPERATURE LOG

Protocol ID:

Protocol title:

Investigational Product:

Principal Investigator:

Confidential

1-1-26
Dr Nithya Gogtay
Professor & Head
Department of Clinical Pharmacology
1st Floor, MS Building
Seth GS Medical College & KEM Hospital
Parel, Mumbai 400 012

